

ERS SERIES

4"/6"/8"/10" ROUND SLIM

INSTALLATION MANUAL

PRODUCT PARAMETER

INPUT VOLTAGE	120V
RATING	DAMP LOCATION
WORKING TEMP.	-4°F ~ 104°F

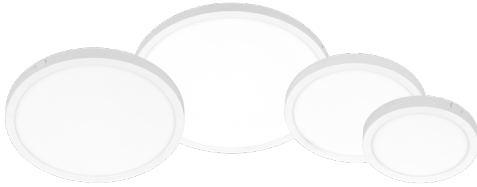

Wattage (W)	Voltage (V)	Rated Input Frequency (Hz)	Beaming (°)	Size (in)
8W	AC120V	60Hz	120°	Φ5x0.6
11W	AC120V	60Hz	120°	Φ5x0.6
14W	AC120V	60Hz	120°	Φ7x0.6
20W	AC120V	60Hz	120°	Φ8x0.6
25W	AC120V	60Hz	120°	Φ12x0.6

SAFETY INFORMATION

BE SURE THE POWER IS OFF! RISK OF ELECTRICAL SHOCK: Always use the switch to power off. Do not perform any operations while this unit is powered on. The electrical system you want to connect the device to must be grounded. Read the instructions before using or powering this device. The safety instructions must remain with the unit in case of transfer. Any damage to the device linked to an inappropriate use is excluded from support by the warranty. Before connecting, make sure that the current and voltage are compatible with this device. We highly recommend that all installations are made by QUALIFIED ELECTRICIAN. We are NOT responsible by any means for the use or misuse of the following information. We are NOT responsible in whole or part for any harm or damage that may or may not be caused. We reserve the right to revise the components of any product, due to part availability or change ETL, CUL, UL standards without assuming any obligation or liability to modify any products previously manufactured and without notice. These instructions do not cover all details of variations in equipment, nor do they provide every possible contingency to be met. Turn off / unplug power when installing or service device.

PRE - INSTALLATION

- Carefully remove the fixture from the carton.
- Before beginning assembly, installation, or operation of product, make sure all parts are present. Compare parts with package contents list and diagram on previous page. If any part is missing or damaged, do not attempt to assemble, install or operate the product. Contact customer service for replacement parts.
- Tools required for assembly (Not Included): screwdriver, phillips screwdriver, pliers, electrical tape, wire cutters, safety glasses, ladder, wire stripper.

WARNING

- WARNING:** Read all safety precautions and installation instructions carefully before installing or servicing this fixture. Failure to comply with these instructions could result in a potentially fatal electric shock, fire, and/or property damage.
- Fixture is designed for use in a circuit protected by a fuse or circuit breaker. It is also designed to be installed in accordance with local electrical codes. If you are unsure about your wiring, consult a qualified electrician or local electrical inspector, and check your local electrical code.
 - Some metal parts in the fixture may have sharp edges. To prevent cuts and scrapes wear gloves when handling the parts
 - Account for small parts and destroy packing material, as these may be hazardous to children.

EMBEDDED INSTALLATION (Caution: Before beginning installation turn off the circuit breaker and light switch)

4" CAN

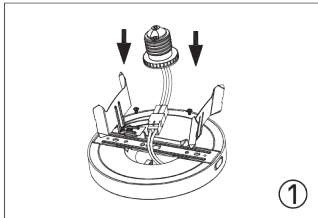

①

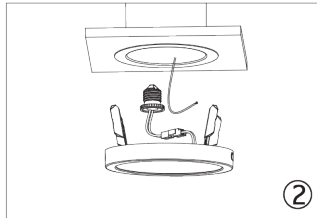

②

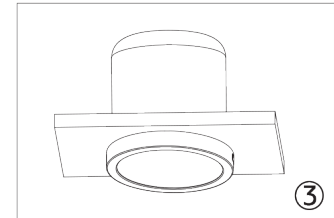

③

5/6" CAN

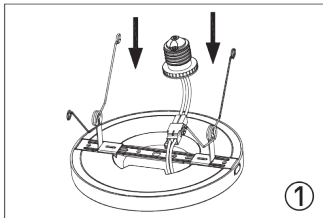

①

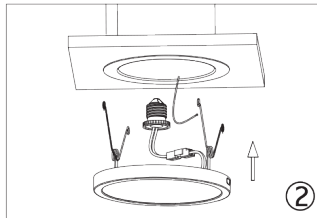

②

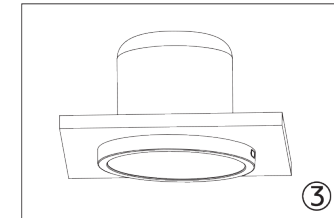

③

Remove trim and existing lamp from recessed fixture

Screw E26 socket adapter into socket in the housing

Press the friction blade to insert the lamp into the housing and restore power.

SURFACE MOUNTING INSTALLATION (Caution: Before beginning installation turn off the circuit breaker and light switch)

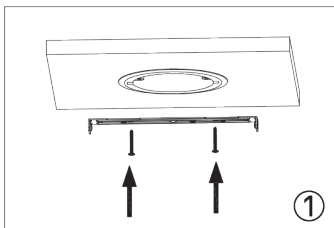

①

Fixing bracket on terminal box

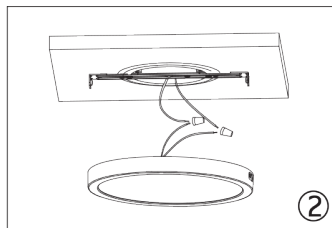

②

Connecting the wire

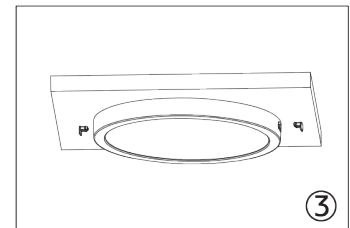

③

Fixing the lamp body on bracket and fix tightly