

INSTALLATION MANUAL

PRODUCT PARAMETER

INPUT VOLTAGE	100-277V
DIMMING	0-10V
MATERIAL	ALUMINUM

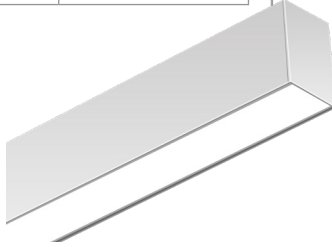

MOUNTING



SURFACE - It is the ideal choice for low ceilings and minimal ceiling spaces. Surface mounted luminaires can be used effectively to enhance architectural features.



WALL - The slender design makes it perfect for corridors, private offices, classrooms, lobbies and general purpose rooms.



PENDANT - Best suited to spaces with generous ceiling heights. Light up the space to improve comfort with the indirect lighting option.

Shock Hazard: May result in serious injury or death. Turn power OFF at circuit breaker prior to installation or servicing.

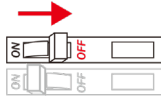

TOOLS REQUIRED

1. Sharp Side Cutter
2. Electric Drill
3. Level
4. Measuring Tool
5. Wire Stripper/ Knife
6. Phillips Screwdrivers
7. Wire Cutters

SAFETY INFORMATION

BE SURE THE POWER IS OFF! RISK OF ELECTRICAL SHOCK: Always use the switch to power off. Do not perform any operations while this unit is powered on. The electrical system you want to connect the device to must be grounded. Read the instructions before using or powering this device. The safety instructions must remain with the unit in case of transfer. Any damage to the device linked to an inappropriate use is excluded from support by the warranty. Before connecting, make sure that the current and voltage are compatible with this device. We highly recommend that all installations are made by QUALIFIED ELECTRICIAN. We are NOT responsible for any means for the use or misuse of the following information. We are NOT responsible in whole or part for any harm or damage that may or may not be caused. We reserve the right to revise the components of any product, due to part availability or change ETL, CUL, UL standards without assuming any obligation or liability to modify any products previously manufactured and without notice. These instructions do not cover all details of variations in equipment, nor do they provide every possible contingency to be met. Turn off / unplug power when installing or service device.

WARNING

WARNING: Read all safety precautions and installation instructions carefully before installing or servicing this fixture. Failure to comply with these instructions could result in a potentially fatal electric shock, fire, and/or property damage.

- Read all instructions

Install in accordance with national and local electric code regulations

This product is intended to be installed and serviced by a qualified, licensed electrician.

Do not install in wet locations. For dry and damp use only.

Turn off electrical power before installing or servicing fixture in any way

To reduce the risk of fire and overheating, make sure all connections are right

Under no circumstances can the lighting fixture be covered with heat insulation gasket or similar materials

The maximum connection of each input line is less than 40FT (1200cm) in 120V, less than 80FT (2400 cm) in 230V, less than 100FT (1300 cm) in 277V.

FCC WARNING

WARNING: Changes or modifications to this unit not expressly approved by the party responsible for compliance could void the user authority to operate the equipment.

NOTES: This equipment has been tested and found to comply with the limits for a Class B digital device, pursuant to Part 15 of the FCC Rules. These limits are designed to provide reasonable protection against harmful interference in a residential installation. This equipment generates, uses and can radiate radio frequency energy and, if not installed and used in accordance with the instructions, may cause harmful interference to radio communications.

However, there is no guarantee that interference will not occur in a particular installation. If this equipment does cause harmful interference to radio or television reception, which can be determined by turning the equipment off and on, the user is encouraged to try to correct the interference by one or more of the following measures:

- Reorient or relocate the receiving antenna.
- Increase the separation between the equipment and receiver.
- Connect the equipment into an outlet on a circuit different from that to which the receiver is connected.
- Consult the dealer or an experienced radio/TV technician for help.

DRY CEILING PENDANT INSTALLATION (Caution: Before beginning installation turn off the circuit breaker and light switch)

POWER FEED

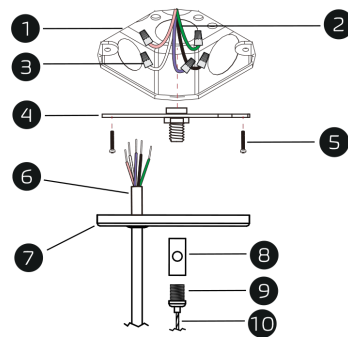

NON POWER SUSPENSION

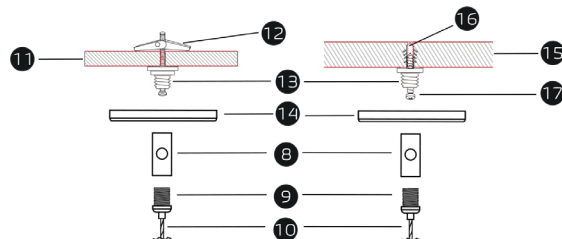

PARTS LIST

- 1 4" Octagon Junction Box (By Others)
- 2 Power Cord (By Others)
- 3 Wire Nut
- 4 Junction Box Crossbar
- 5 Screw PM4*22
- 6 Power Cord
- 7 4" Power Canopy Kit
- 8 Cable Holder
- 9 Strain Relief Thread Nut
- 10 Aircraft Cable
- 11 Drywall Ceiling (By Others)
- 12 Butterfly Drywall Anchor
- 13 Crimp Stud
- 14 2" Canopy
- 15 Solid Ceiling (By Others)
- 16 Anchor
- 17 Screw PA4*30

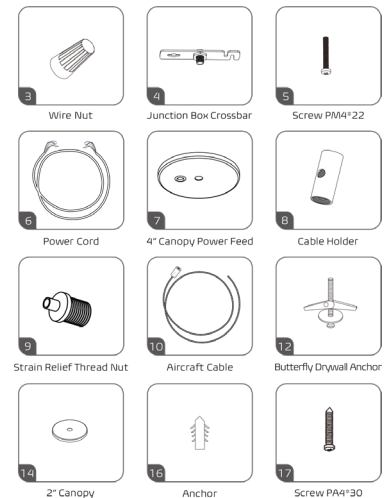

INSTALLATION MANUAL

DROP CEILING (T-GRID CLIPS) PENDANT INSTALLATION (Caution: Before beginning installation turn off the circuit breaker and light switch)

PARTS LIST

- 1 Armored Cable & Connector (By Others)
- 2 Power Cord (By Others)
- 3 4" Octagon Junction Box
- 4 Wire Nut
- 5 Assembled T-grid Clips
- 6 Screw 6#*4
- 7 T-grid (By Others)
- 8 Plastic Grommet
- 9 Ceiling Tile (By Others)
- 10 Power Cord
- 11 4" Canopy Power Feed
- 12 Cable Holder
- 13 Strain Relief Thread Nut
- 14 Aircraft Cable
- 15 2" Canopy

POWER FEED

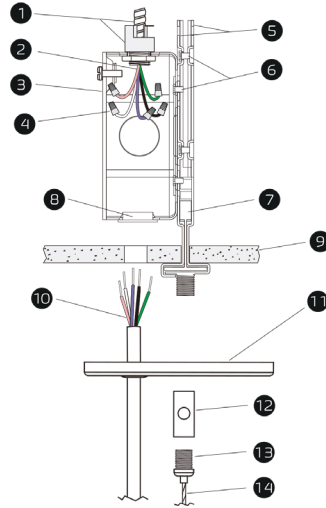

NON POWER SUSPENSION

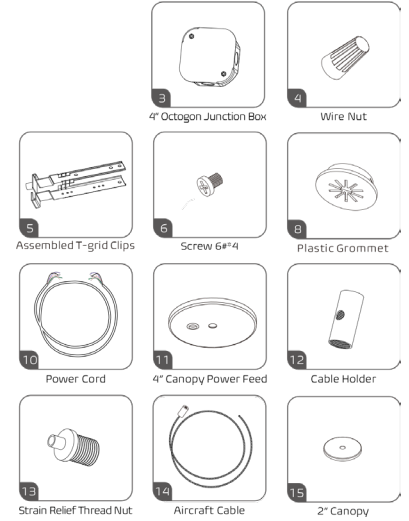
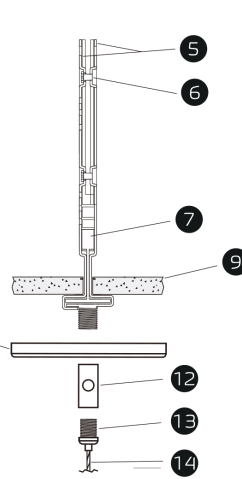

JOINER OPTIONS

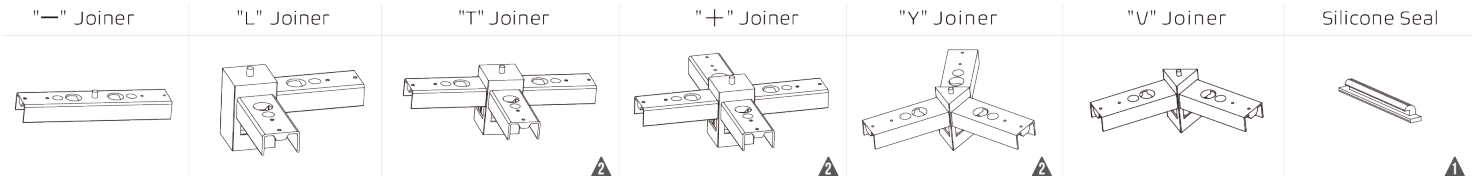

WIRING

CORD/SUPPLY WIRING

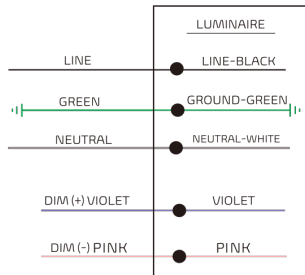

PRE-INSTALLATION

Disassemble luminaires as shown below

Start of run (SoR): Remove the end cap without power code, and take the LED module out.

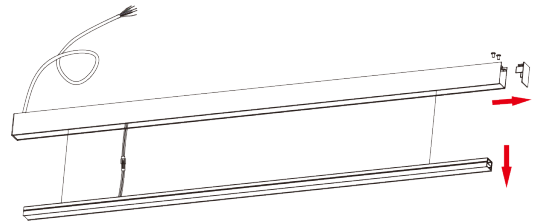

Middle of run (MoR): Remove both end caps, and take the LED module out.

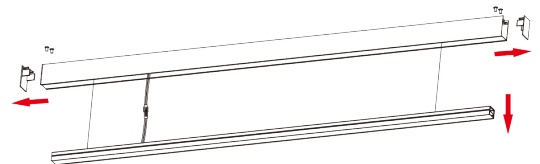

End of run (EoR): Remove the end cap with power code, and take the LED module out.

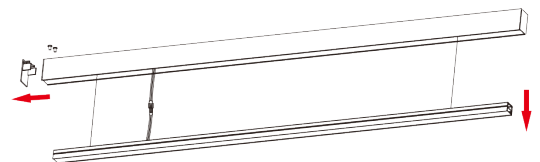

INSTALLATION MANUAL

INDEPENDENT INSTALLATION (Caution: Before beginning installation turn off the circuit breaker and light switch)

STEP 1 HAND LUMINAIRE

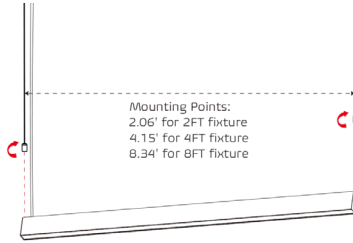

Screw both bottom parts of aircraft cables clockwise and secure then on the top of housing making sure they hang the lights.

STEP 2 COMPLETE

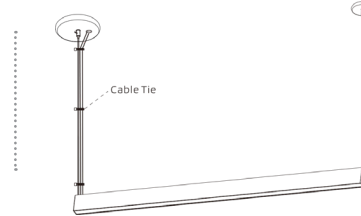

Use the cable tie to keep the electric wire going up along the wire rope.

MULTIPLE LUMINAIRE INSTALLATION (Caution: Before beginning installation turn off the circuit breaker and light switch)

A. LINE CONNECTION

STEP 1 INSTALL JOINERS

Screw the joiner "J" to the MoR aircraft cable in turn.

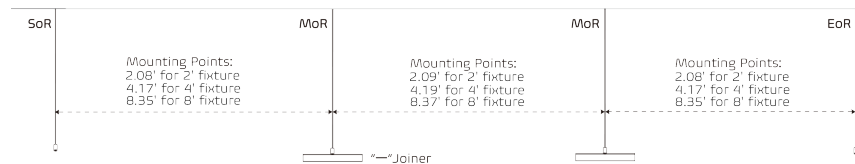

STEP 2 HANG LUMINAIRE AND WIRING - SoR

- 2-1: Insert the joiner "J" into luminaire from one side and fix it with screws.
- 2-2: Screw both bottom part of aircraft cables clockwise and secure then on the top of housing making sure they hang the lights.

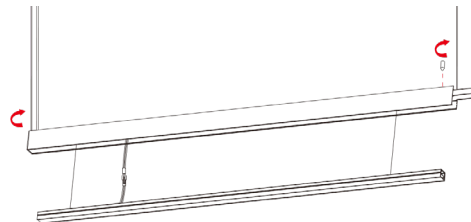

⚠ Adjust the height of the luminaire
Luminaire can be raised by pulling cable through the gripper and can be lowered by depressing the top cylinder on the gripper which pulls the luminaire down.

STEP 3 REPEAT HANG AND JOIN STEPS - MoR to EoR

- 3-1: Zip tight power cord & air craft suspension cable with cable tie.
- 3-2: Connect the quick connectors properly.
- 3-3: Insert all the LED modules into the housing from SoR to EoR in turn.

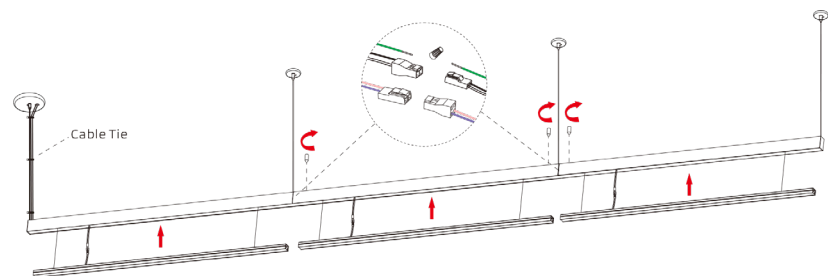

INSTALLATION MANUAL

MULTIPLE LUMINAIRE INSTALLATION (Caution: Before beginning installation turn off the circuit breaker and light switch)

STEP 4
COMPLETE

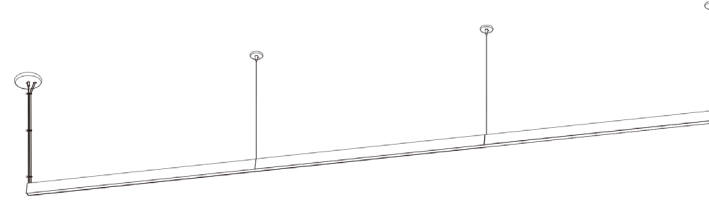

43' DIFFUSER LENS ROLL

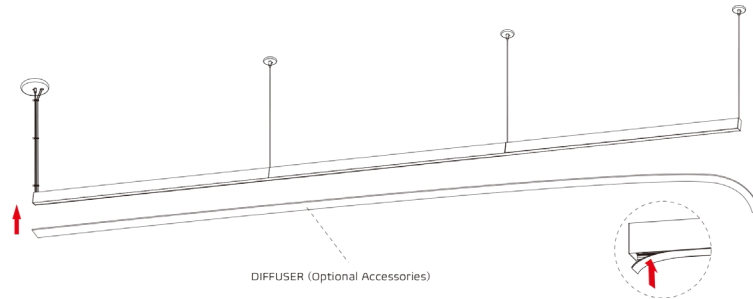

MULTIPLE LUMINAIRE INSTALLATION (Caution: Before beginning installation turn off the circuit breaker and light switch)

B. L SHAPE CONNECTION

- ▲ For "T", "+", "Y" shape or other geometric shapes, all subject to the "L" shape installation
- ▲ It needs 2 inputs if using joiner "T", "+", and "Y"

STEP 1
INSTALL JOINERS

Screw the joiner "L" to the MoR aircraft cable in turn

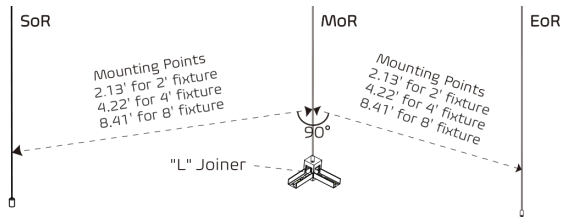

STEP 2
HANG LUMINAIRE AND JOIN

- 2-1: Insert the joiner "L" into luminaire from one side and fix it with screws
- 2-2: Screw both bottom parts of aircraft cables clockwise and secure them on the top of housing making sure they hang the lights.

- ▲ Adjust the height of the luminaire
Luminaire can be raised by pulling cable through the gripper and can be lowered by depressing the top cylinder on the gripper which pulls the luminaire down.

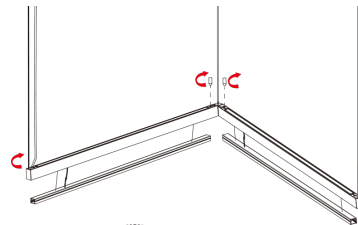

STEP 3
CONNECT

- 3-1: Zip tight power cord & aircraft suspension cable with the cable tie.
- 3-2: Connect the quick connectors properly.
- 3-3: Insert all the LED modules into the housing from SoR to EoR in turn

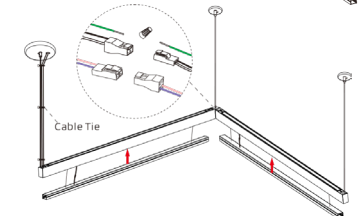

STEP 4
COMPLETE

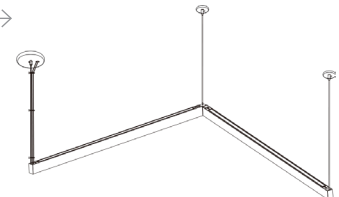

INSTALLATION MANUAL

PENDANT CONTINUOUS RUN INSTALL INSTRUCTION

JOINER OPTIONS

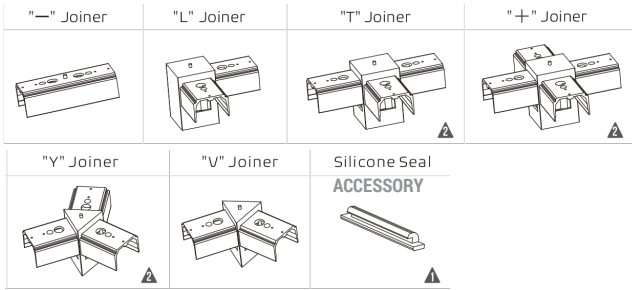

▲ Noted: Silicone seal is used to seal seams that may appear at both ends of luminaires when multiple connections.

▲ It needs 2 inputs if using joiner "T", "+", "Y"

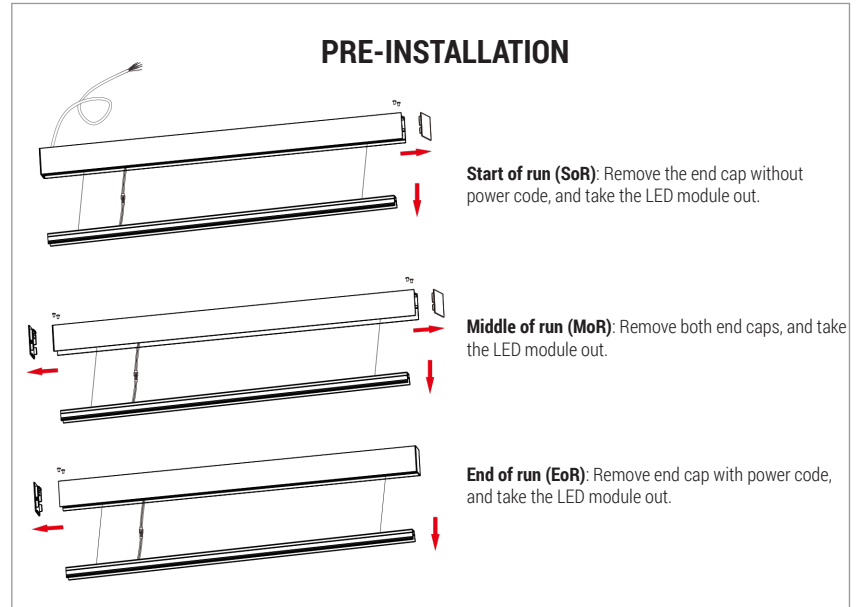

SINGLE DIRECTION CONNECTION

STEP 1: INSTALL JOINERS

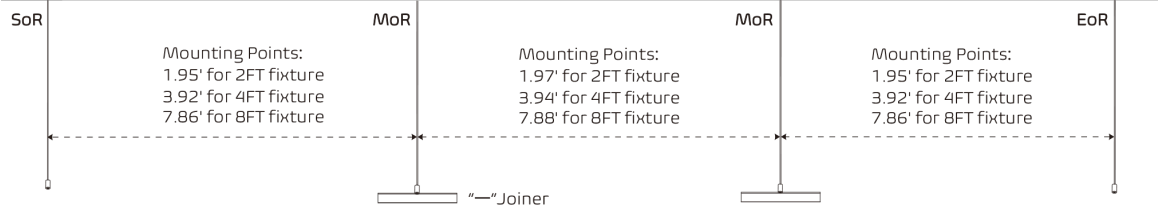

Screw the joiner "-" to the MoR aircraft cable in turn.

STEP 2: HANG LUMINAIRE AND WIRING - SOR

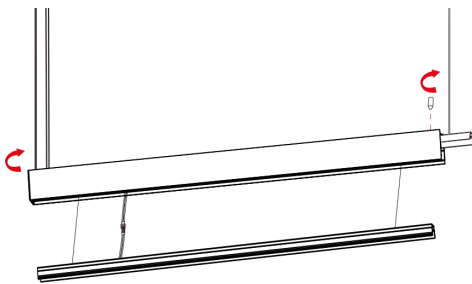

▲ Adjust the height of luminaire

Luminaire can be raised by pulling cable through the gripper and can be lowered by depressing the top cylinder on the gripper which pulls the luminaire down.

2-1: Inset the joiner into luminaire from on side and fix it with screws

2-2: Screw both bottom parts of aircraft cables clockwise and secure then on the top of housing making sure they hang the lights.

STEP 3: REPEAT HANG AND JOIN STEPS

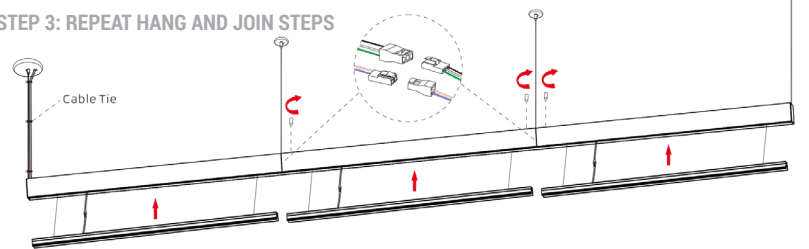

- 3-1: Zip tight power cord & aircraft suspension cable with the cable tie
- 3-2: Connect the quick connectors properly
- 3-3: Insert all the LED Modules into the housing from SoR to EoR in turn

STEP 4: COMPLETE

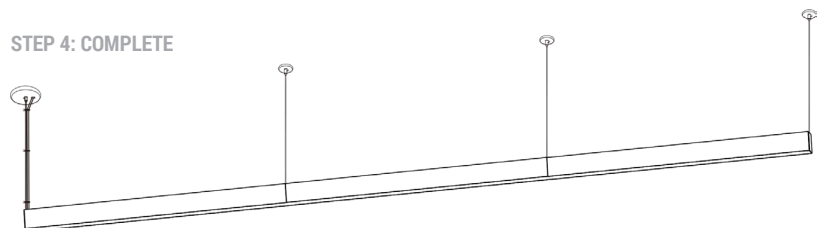

INSTALLATION MANUAL

MULTIPLE LUMINAIRE INSTALLATION (Caution: Before beginning installation turn off the circuit breaker and light switch)

MULTI DIRECTION CONNECTION

▲ For "T", "+", "Y" shape or other geometric shapes all subject to the "L" shape installation

▲ It needs 2 inputs if using joiner "T", "+", "Y"

STEP 1: INSTALL JOINERS

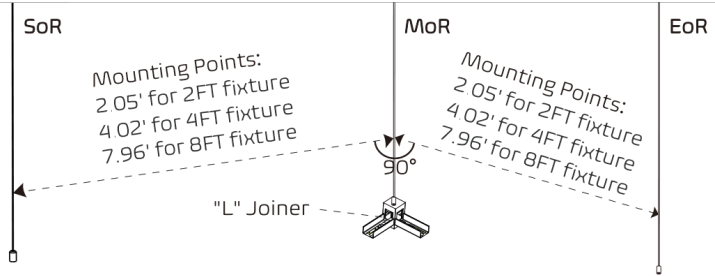

Screw the joiner "L" to the MoR aircraft cable in turn.

STEP 2: HANG LUMINAIRE AND JOIN

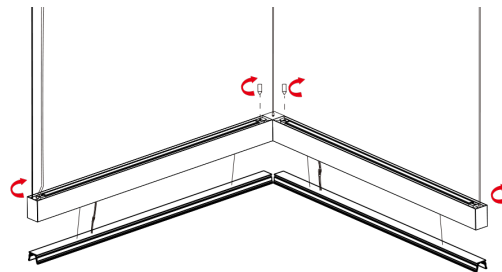

2-1: Inset the joiner "L" into luminaire from on side and fix it with screws
2-2: Screw both bottom parts of aircraft cables clockwise and secure then on the top of housing making sure they hang the lights.

▲ Adjust the height of luminaire

Luminaire can be raised by pulling cable through the gripper and can be lowered by depressing the top cylinder on the gripper which pulls the luminaire down.

STEP 3: CONNECT

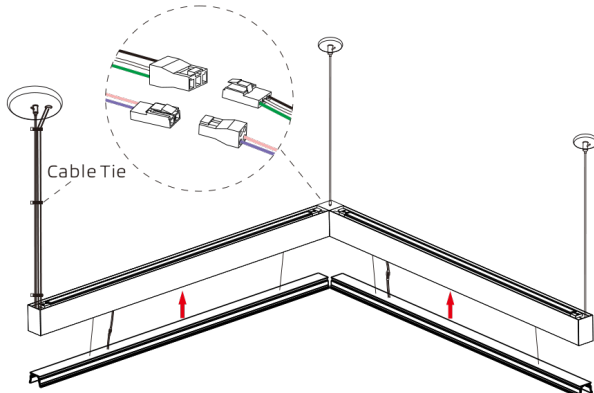

3-1: Zip tight power cord & aircraft suspension cable with the cable tie
3-2: Connect the quick connectors properly
3-3: Insert all the LED Modules into the housing from SoR to EoR in turn

STEP 4: COMPLETE

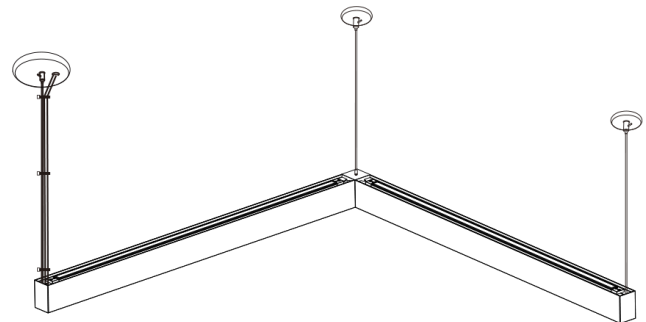

TROUBLE SHOOTING

PROBLEM	POSSIBLE CAUSE	SOLUTION
Light will not come on	A. Light switch is turned off. B. Fuse is blown or circuit breaker is turned off. C. Incorrect circuit wiring	A. Turn light switch on B. Replace fuse or turn circuit breaker on C. Verify that fixture is wired properly

CARE AND MAINTENANCE

CAUTION: Before attempting to clean the fixture, disconnect the power to the fixture by turning the breaker off or removing the fuse from the fuse box. This LED light fixture is made from quality materials that will last many years with minimum care and maintenance. You may want to clean the fixture with a soft cloth periodically. To maintain the best appearance of the fixture, do not use cleaners with chemicals, solvents or harsh abrasives. Do not use liquid cleaner on the LEDs, LED driver, or wiring inside the light fixture.

INSTALLATION MANUAL

SURFACE INSTALLATION (Caution: Before beginning installation turn off the circuit breaker and light switch)

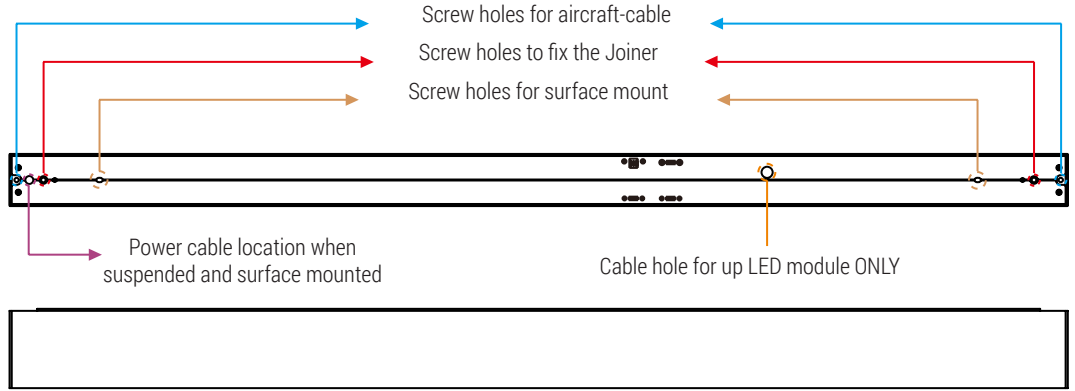
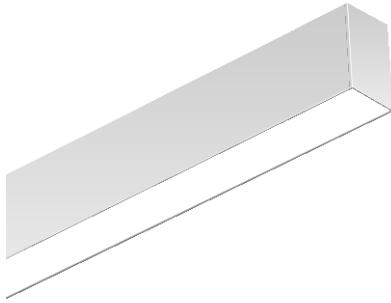

ACCESSORY

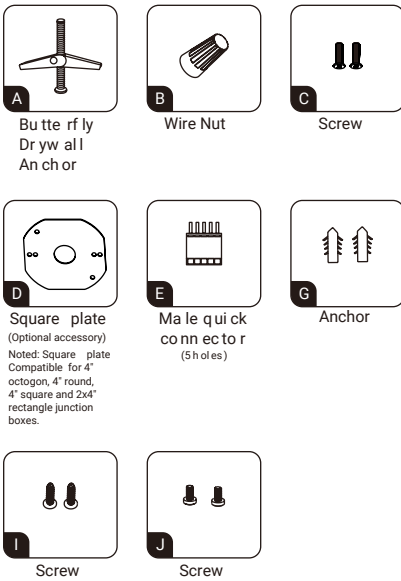

INDEPENDENT INSTALLATION

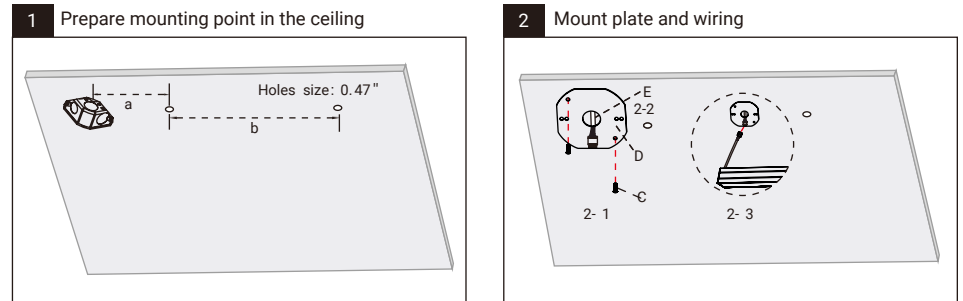

a: The center distance between the ceiling hole and the junction box.
b: The distance between two ceiling hole.

2-1: Cover the junction box with square plate "D" and fix it with screw "C", then plastering.
2-3: Plug in the male and female connector together, hide all wires into the junction box.
2-2: Plug in AC wires, dimming wires and

Nominal Length	2.3" Width Linear (Diffuser, Regress, Wall Wash)		2.3" Width Linear (Reflector, Louver)	
	"a"	"b"	a"	b"
2ft.	0.26'	1.30'	0.26'	1.31'
3ft.	0.26'	2.30'	0.26'	2.30'
4ft.	0.26'	3.30'	0.26'	3.28'
8ft.	0.26'	7.26'	0.26'	7.22'

WIRING

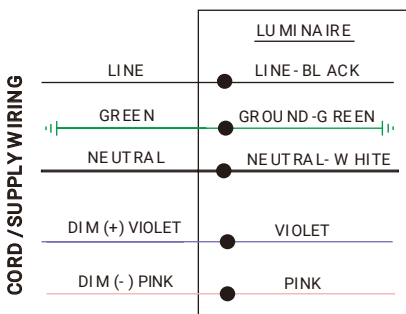

! Please isolate two dimming wires by P2 term in all individual if no need dimming; **MUST connect wires with corresponding colors as shown.**

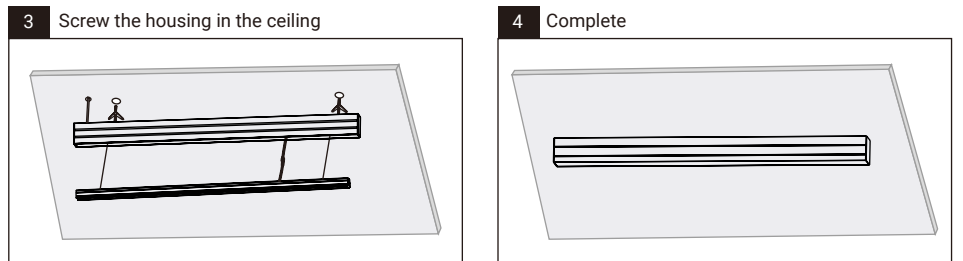

3-1: Fix the housing in the ceiling with butterfly drywall anchor "A".
Remark: Fix the housing with screws "I" if wooden frame ceiling. Fix the housing with anchor "G" and Screws "J" if cement drywall.
3-2: Press the LED modular into housing.

RAIL 2

ARCHITECTURAL LINEAR

JOINER OPTIONS

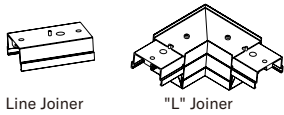

Noted: It needs 2 inputs if using joiner "T", "+" and "Y".

ACCESSORY



Noted: Silicone Seal is used to seal seams that may appear at both ends of luminaires when multiple connections.

BEFORE CONNECTING

Disassemble Luminaires

LINE CONNECTION



Start of run (SoR):

Install the power feed cable, head end cap and endmost line joiner. Meanwhile secure the down module to the housing with aircraft cable.

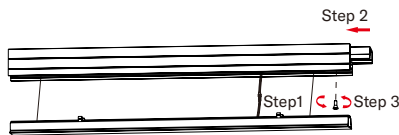

Middle of run (MoR):

Install the endmost line joiner, and secure the down module to the housing with aircraft cable.



End of run (EoR):

Install the endmost end cap, and secure the down module to the housing with aircraft cable.

L SHAPE CONNECTION

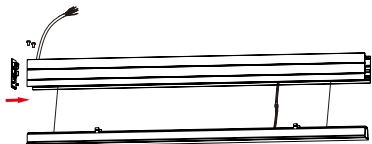

Start of run (SoR):

Install the power feed cable and head end cap. Meanwhile secure the down module to the housing with aircraft cable.

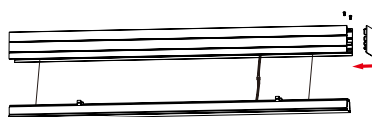

End of run (EoR):

Install the endmost end cap, and secure the down module to the housing with aircraft cable.

LINE CONNECTION

1 Prepare mounting point in the ceiling

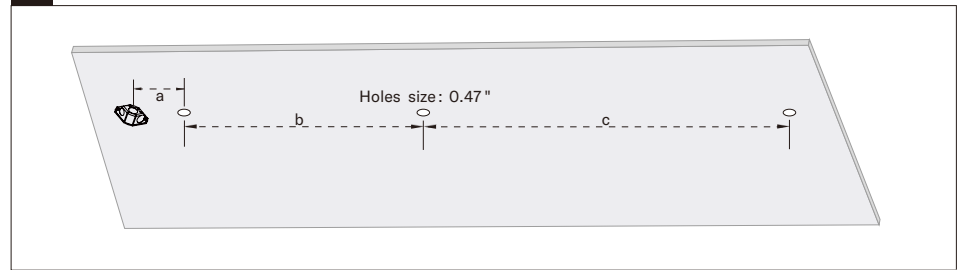

2.3' Width Linear (Diffuser, Regress, Wall Wash)			2.3' Width Linear (Reflector, Louver)		
a	b	c	a	b	c
Feet	Feet	Feet	Feet	Feet	Feet
0.26'	1.30'	1.96'	0.26'	1.31'	1.97'
0.26'	2.30'	2.96'	0.26'	2.30'	2.95'
0.26'	3.30'	3.96'	0.26'	3.28'	3.94'
0.26'	7.26'	7.92'	0.26'	7.22'	7.87'

2 Mount plate and wiring

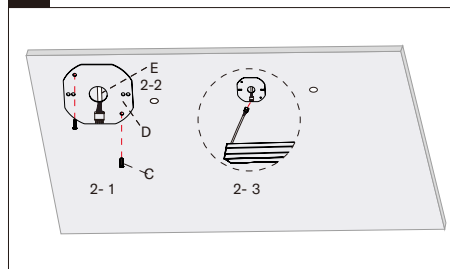

2-1: Cover the junction box with square plate "D" and fix it with screw "C", then plastering.

2-2: Plug in AC wires, dimming wires and ground wire into the male quick connector (5holes) "E" according to label instructions.

2-3: Plug in the male and female connector together, hide all wires into the junction box.

3 Install the housing and joiner - SoR

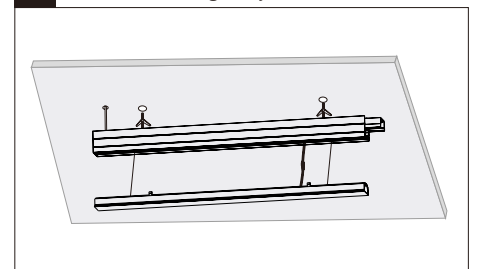

3-1: Fix the housing in the ceiling with butterfly drywall anchor "A".

Remark: Fix the housing with screws "I" if wooden frame ceiling. Fix the housing with Anchor "G" and Screws "I" if cement drywall.

4 Repeat install and join steps-MoR to EoR

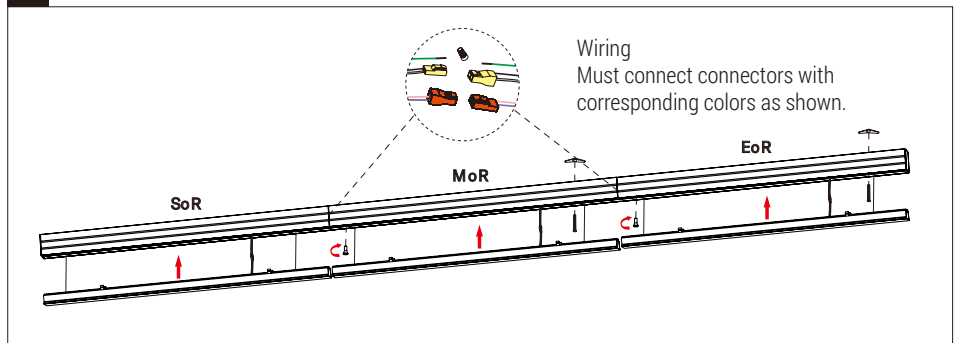

4-1: Fix the housing in the ceiling in turn.

4-2: Connect the quick connectors properly.

4-3: Insert all the led modules into the housing from SoR to EoR in turn.

RAIL 2

ARCHITECTURAL LINEAR

SURFACE INSTALLATION (Caution: Before beginning installation turn off the circuit breaker and light switch)

5 Complete

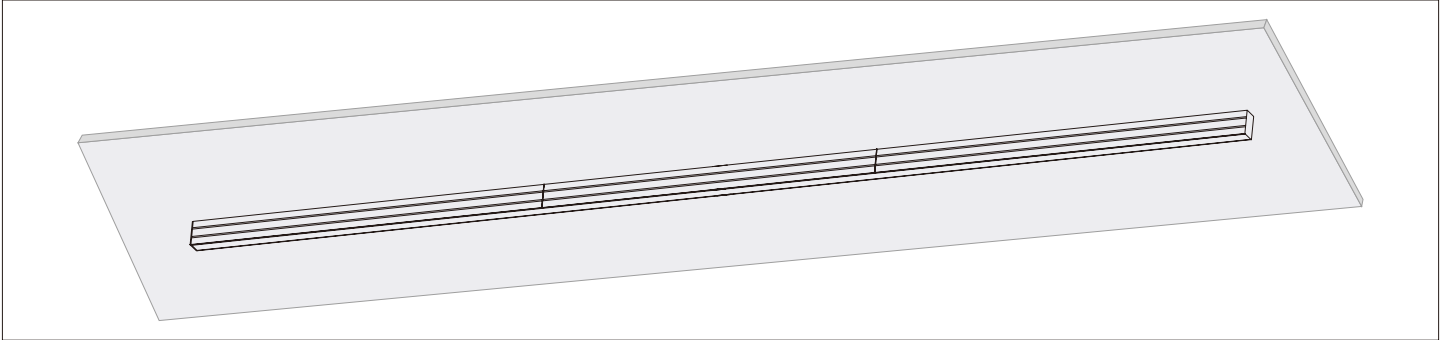

Optional 42' Diffuser Lens Roll

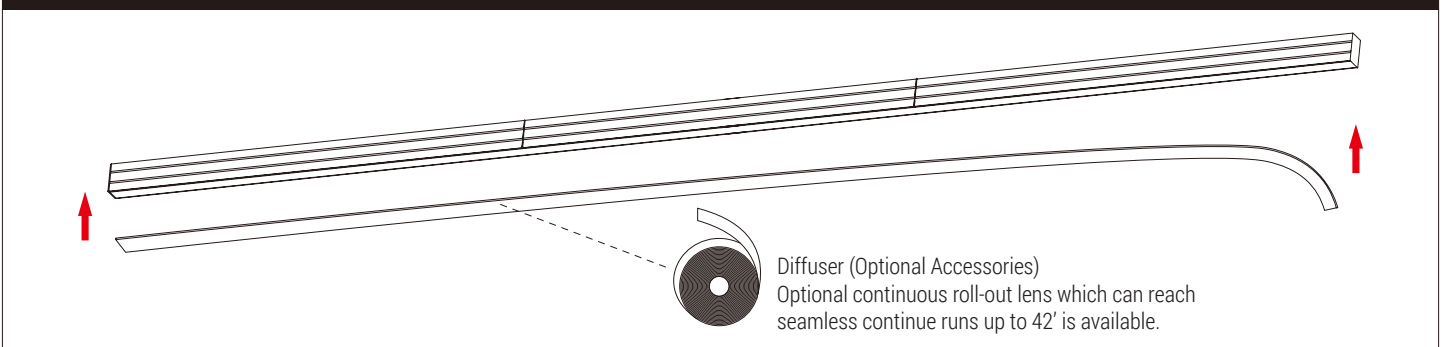

L SHAPE CONNECTION

- ▲ For "T", "+", "Y" shape or other geometric shapes, all subject to the "L" shape
- ▲ It needs 2 inputs if using joiner "T", "+" and "Y".

1 Make hole in the ceiling

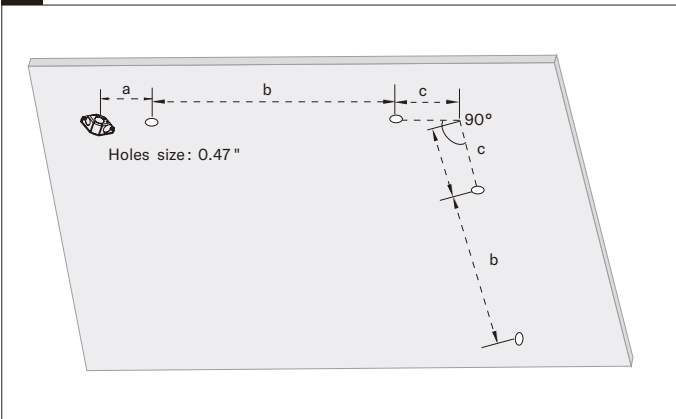

2 Mount plate and wiring

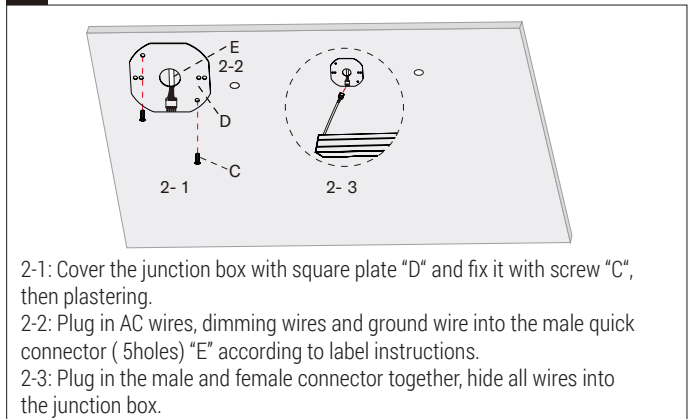

2.3" Width Linear (Diffuser, Regress, Wall Wash)				2.3" Width Linear (Reflector, Louver)		
"a"	"b"	"C" Illuminated "L" Joiner	"C" Non-luminous "L" Joiner	"a"	"b"	"C" Non-luminous "L" Joiner
Feet	Feet	Feet	Feet	Feet	Feet	Feet
0.26	1.30	.33'	0.10	.26'	1.31'	0.10'
0.26	2.30	.33'	0.10	.26'	2.30'	0.10'
0.26	3.30	.33'	0.10	.26'	3.28'	0.10'
0.26	7.26	.33'	0.10	.26'	7.22'	0.10'

RAIL 2

ARCHITECTURAL LINEAR

SURFACE INSTALLATION (Caution: Before beginning installation turn off the circuit breaker and light switch)

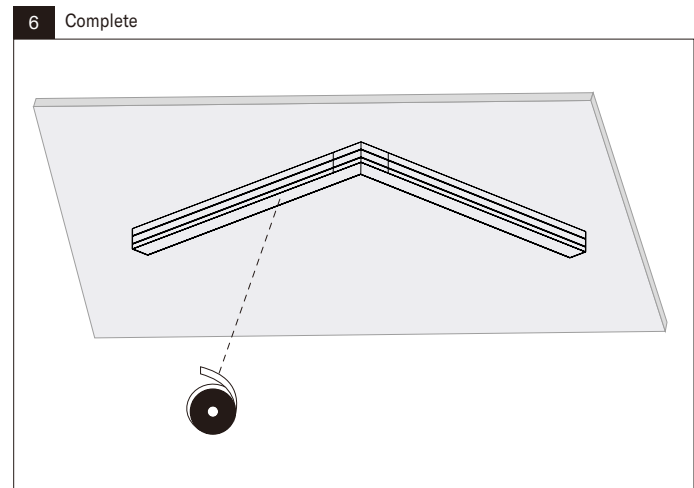
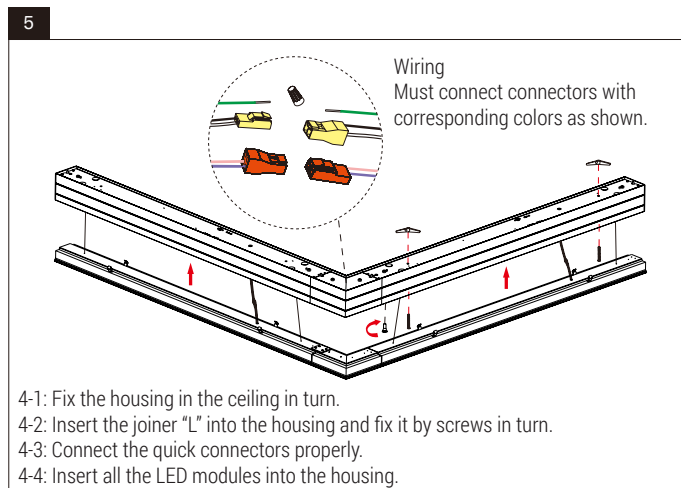
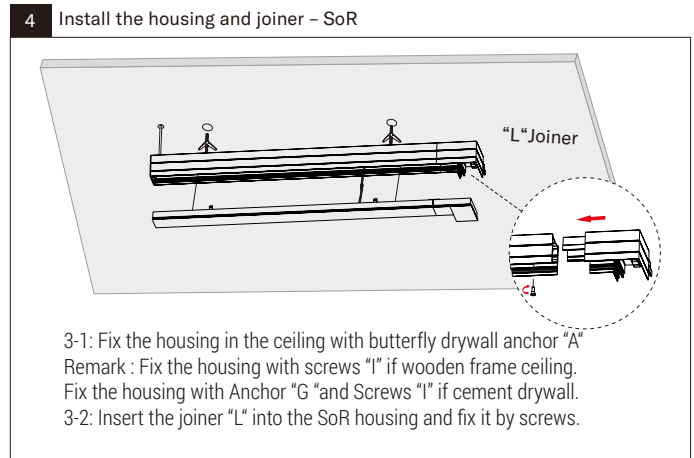
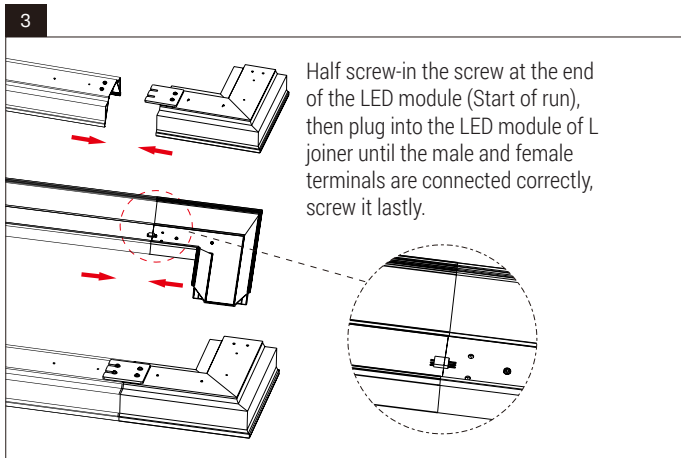

Diffuser (Optional Accessories)
Optional continuous roll-out lens which can reach seamless continue runs up to 42' is available.

TROUBLE SHOOTING

PROBLEM	POSSIBLE CAUSE	SOLUTION
Light will not come on	A. Light switch is turned off. B. Fuse is blown or circuit breaker is turned off. C. Incorrect circuit wiring	A. Turn light switch on B. Replace fuse or turn circuit breaker on C. Verify that fixture is wired properly

CARE AND MAINTENANCE

CAUTION: Before attempting to clean the fixture, disconnect the power to the fixture by turning the breaker off or removing the fuse from the fuse box. This LED light fixture is made from quality materials that will last many years with minimum care and maintenance. You may want to clean the fixture with a soft cloth periodically. To maintain the best appearance of the fixture, do not use cleaners with chemicals, solvents or harsh abrasives. Do not use liquid cleaner on the LEDs, LED driver, or wiring inside the light fixture.