

SKY BRIDGE SERIES

VERTICAL PENDANT LUMINAIRE

INSTALLATION MANUAL

PRODUCT PARAMETER	
INPUT VOLTAGE	120 - 277V
FEATURE	DAMP LOCATION
MATERIAL	ALUMINUM HOUSING

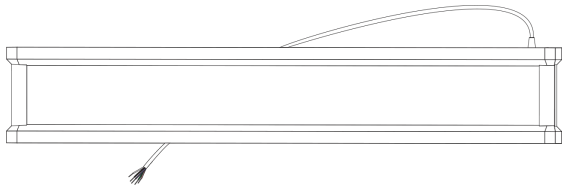

SAFETY INFORMATION

BE SURE THE POWER IS OFF! RISK OF ELECTRICAL SHOCK: Always use the switch to power off. Do not perform any operations while this unit is powered on. The electrical system you want to connect the device to must be grounded. Read the instructions before using or powering this device. The safety instructions must remain with the unit in case of transfer. Any damage to the device linked to an inappropriate use is excluded from support by the warranty. Before connecting, make sure that the current and voltage are compatible with this device. We highly recommend that all installations are made by QUALIFIED ELECTRICIAN. We are NOT responsible by any means for the use or misuse of the following information. We are NOT responsible in whole or part for any harm or damage that may or may not be caused. We reserve the right to revise the components of any product, due to part availability or change ETL, CUL, UL standards without assuming any obligation or liability to modify any products previously manufactured and without notice. These instructions do not cover all details of variations in equipment, nor do they provide every possible contingency to be met. Turn off / unplug power when installing or service device.

FCC WARNING

WARNING: Changes or modifications to this unit not expressly approved by the party responsible for compliance could void the user authority to operate the equipment.

NOTES: This equipment has been tested and found to comply with the limits for a Class B digital device, pursuant to Part 15 of the FCC Rules. These limits are designed to provide reasonable protection against harmful interference in a residential installation. This equipment generates, uses and can radiate radio frequency energy and, if not installed and used in accordance with the instructions, may cause harmful interference to radio communications. However, there is no guarantee that interference will not occur in a particular installation. If this equipment does cause harmful interference to radio or television reception, which can be determined by turning the equipment off and on, the user is encouraged to try to correct the interference by one or more of the following measures:

- Reorient or relocate the receiving antenna.
- Increase the separation between the equipment and receiver.
- Connect the equipment into an outlet on a circuit different from that to which the receiver is connected.
- Consult the dealer or an experienced radio/TV technician for help.

PRE - INSTALLATION

- Carefully remove the fixture from the carton.
- Before beginning assembly, installation, or operation of product, make sure all parts are present. Compare parts with package contents list and diagram on previous page. If any part is missing or damaged, do not attempt to assemble, install or operate the product. Contact customer service for replacement parts.
- Tools required for assembly (Not Included): screwdriver, phillips screwdriver, pliers, electrical tape, wire cutters, safety glasses, ladder, wire stripper.

WIRING DIAGRAM

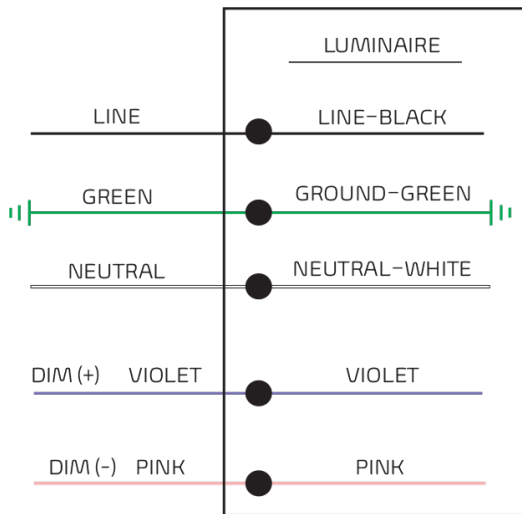

ATTENTION

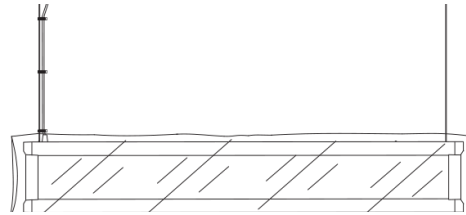

1. Leave the protective bag and protective films on the fixtures until construction and furniture are complete.
2. Fixture can be operated as normal with the bag on.



SHOCK HAZARD!

May result in serious injury or death.
Turn power OFF at circuit breaker prior to installation or servicing.

SKY BRIDGE SERIES

VERTICAL PENDANT LUMINAIRE

INSTALLATION MANUAL

DRY CEILING - SURFACE J-BOX (Caution: Before beginning installation turn off the circuit breaker and light switch)

POWER FEED

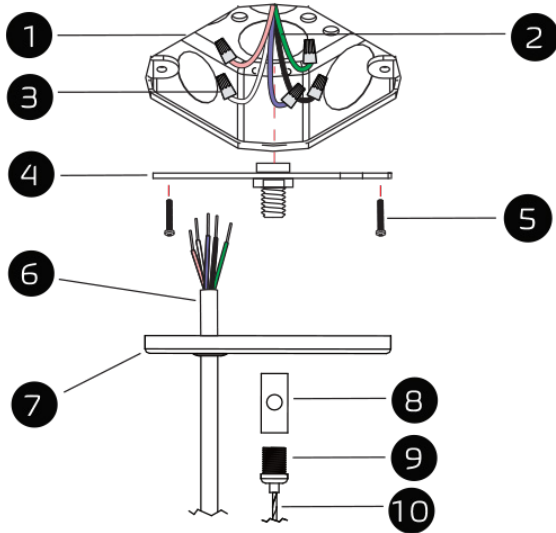

NON POWER SUSPENSION

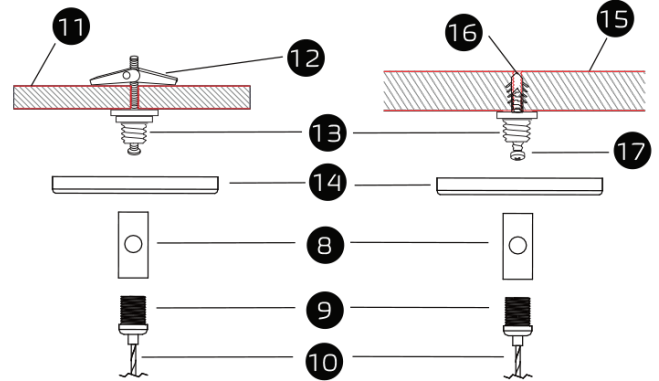

PARTS LIST

- 1 4" Octagon Junction Box (By Others) -----
- 2 Power Cord (By Others) -----
- 3 Wire Nut -----
- 4 Junction Box Crossbar -----
- 5 Screw PM4*22 -----
- 6 Power Cord -----
- 7 4" Power Canopy Kit -----
- 8 Cable Holder -----
- 9 Strain Relief Thread Nut -----
- 10 Aircraft Cable -----
- 11 Drywall Ceiling (By Others) -----
- 12 Butterfly Drywall Anchor -----
- 13 Crimp Stud -----
- 14 2" Canopy -----
- 15 Solid Ceiling (By Others) -----
- 16 Anchor -----
- 17 Screw PA4*30 -----

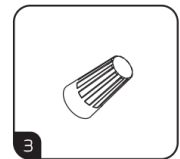

Wire Nut

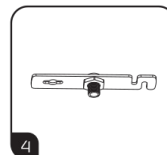

Junction Box Crossbar

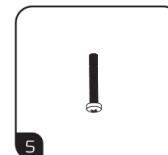

Screw PM4*22

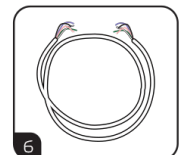

Power Cord

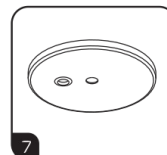

4" Canopy Power Feed

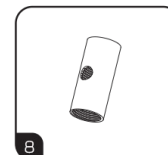

Cable Holder

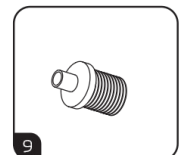

Strain Relief Thread Nut

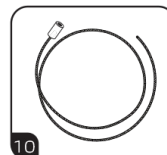

Aircraft Cable

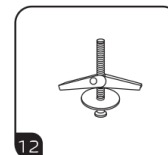

Butterfly Drywall Anchor

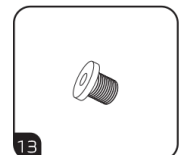

Crimp Stud

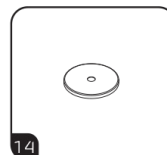

2" Canopy

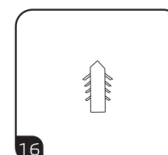

Anchor

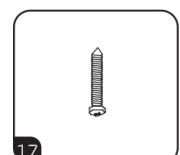

Screw PA4*30

WARNING

RISK OF FIRE AND ELECTRICAL SHOCK. FIXTURE MUST BE INSTALLED BY A QUALIFIED ELECTRICIAN ONLY IN ACCORDANCE WITH NATIONAL, LOCAL BUILDING AND ELECTRICAL CODES. DISCONNECT POWER AT ELECTRICAL PANEL BEFORE SERVICING.

SKY BRIDGE SERIES

VERTICAL PENDANT LUMINAIRE

INSTALLATION MANUAL

DROP CEILING - T-GRID CLIPS (Caution: Before beginning installation turn off the circuit breaker and light switch)

▶▶ POWER FEED

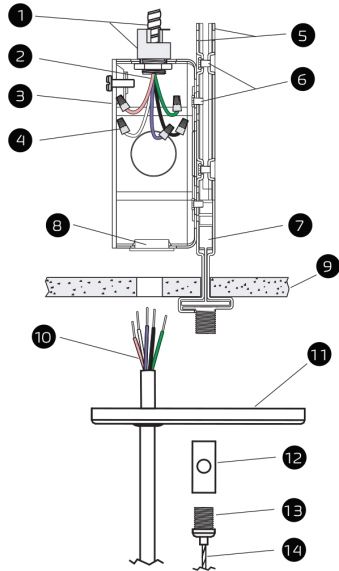

▶▶ NON POWER SUSPENSION

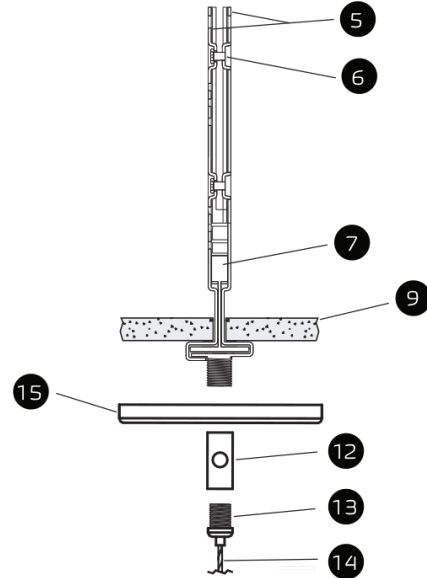

▶▶ PARTS LIST

- 1 Armored Cable & Connector (By Others)
- 2 Power Cord (By Others)
- 3 4" Octagon Junction Box
- 4 Wire Nut
- 5 Assembled T-grid Clips
- 6 Screw 6#*4
- 7 T-grid (By Others)
- 8 Plastic Grommet
- 9 Ceiling Tile (By Others)
- 10 Power Cord
- 11 4" Canopy Power Feed
- 12 Cable Holder
- 13 Strain Relief Thread Nut
- 14 Aircraft Cable
- 15 2" Canopy

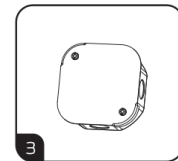

4" Octagon Junction Box

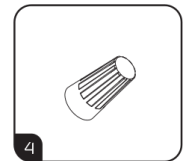

Wire Nut

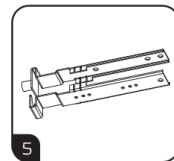

Assembled T-grid Clips

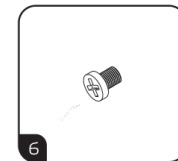

Screw 6#*4

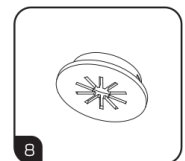

Plastic Grommet

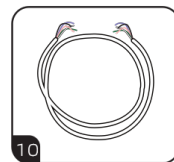

Power Cord

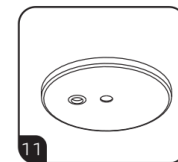

4" Canopy Power Feed

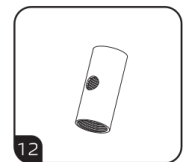

Cable Holder

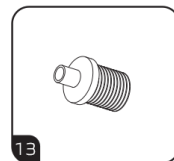

Strain Relief Thread Nut

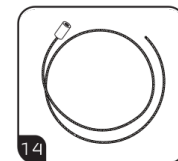

Aircraft Cable

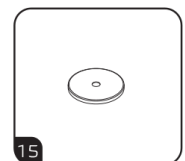

2" Canopy

WARNING

RISK OF FIRE AND ELECTRICAL SHOCK. FIXTURE MUST BE INSTALLED BY A QUALIFIED ELECTRICIAN ONLY IN ACCORDANCE WITH NATIONAL, LOCAL BUILDING AND ELECTRICAL CODES. DISCONNECT POWER AT ELECTRICAL PANEL BEFORE SERVICING.

SKY BRIDGE SERIES

VERTICAL PENDANT LUMINAIRE

INSTALLATION MANUAL

INDEPENDENT INSTALLATION (Caution: Before beginning installation turn off the circuit breaker and light switch)

STEP 1: Hang Luminaire(s)

Screw both bottom parts of aircraft cables clockwise and secure them on top of housing making sure they hang the lights.

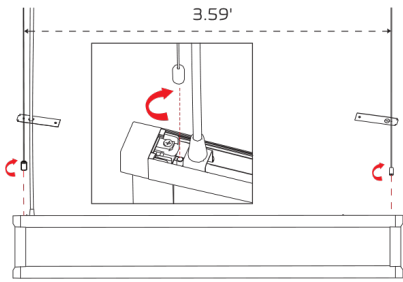

STEP 2: Complete and Remove Bag

2-1: Secure cover plates on both ends of the fixture.
2-2: Zip tight power cord & aircraft suspension cable with the cable tie.

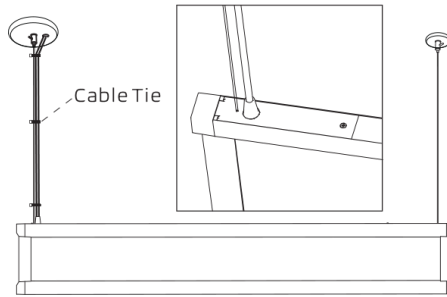

MULTIPLE LUMINAIRE INSTALLATION (Caution: Before beginning installation turn off the circuit breaker and light switch)

PRE-INSTALLATION: Disassemble luminaire's end cap as shown below.

Start of run (SoR): Remove the end cap without power code;
Refer to : ①

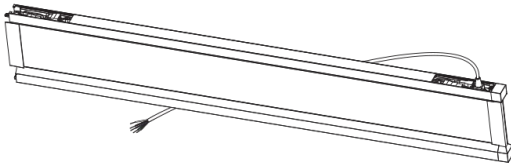

Middle of run (MoR): Remove both end caps
Refer to : ①②③④

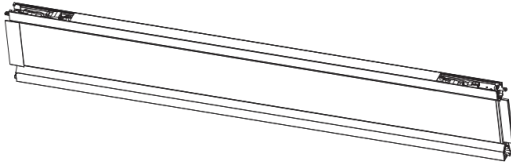

End of run (EoR): Remove the end cap with power code
Refer to : ②③④

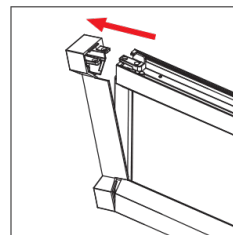
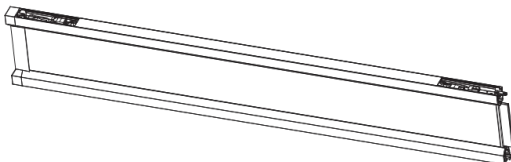

① Take off the end cap (Non-power feed) by screwdriver

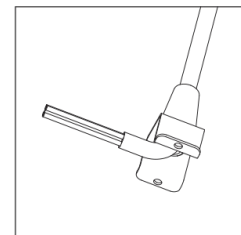

③ Take off the AC cable

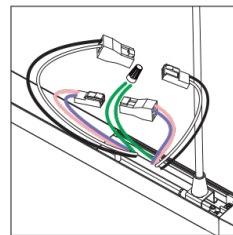

② Pull out the AC cable by removing 2pcs screws.

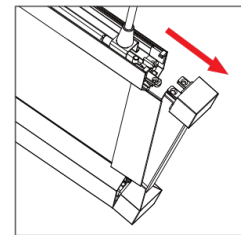

④ Take off the end cap (Power feed) by screwdriver

SKY BRIDGE SERIES

VERTICAL PENDANT LUMINAIRE

INSTALLATION MANUAL

MULTIPLE LUMINAIRES INSTALLATION (Caution: Before beginning installation turn off the circuit breaker and light switch)

STEP 1: Hang Luminaire(s) and wiring - SoR

Screw both bottom parts of aircraft cables clockwise and secure them on top of housing making sure they hang the lights.

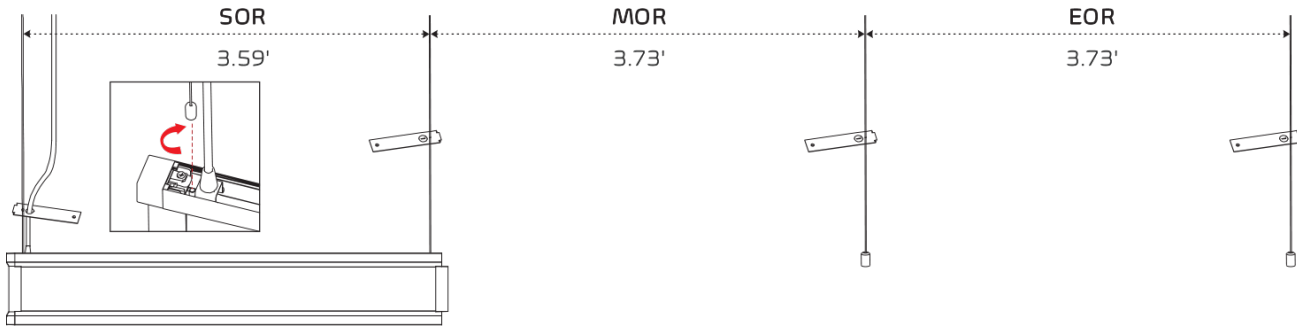

STEP 2: Hang & Join Fixtures (MoR or EoR)

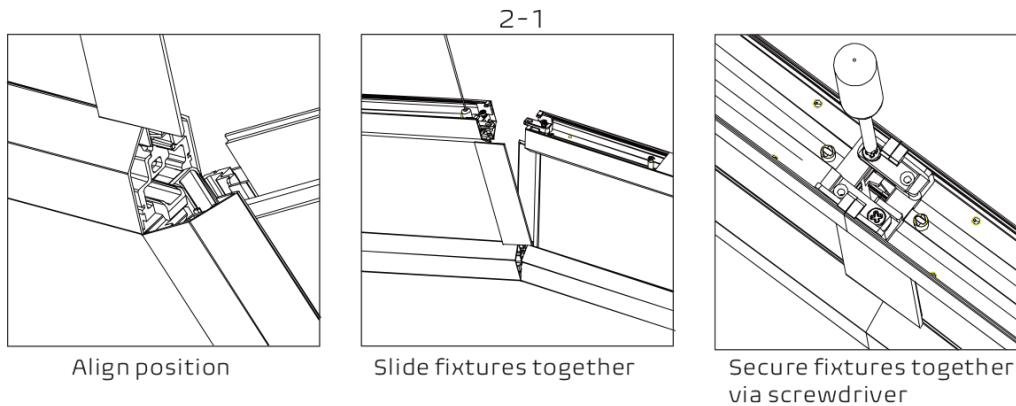
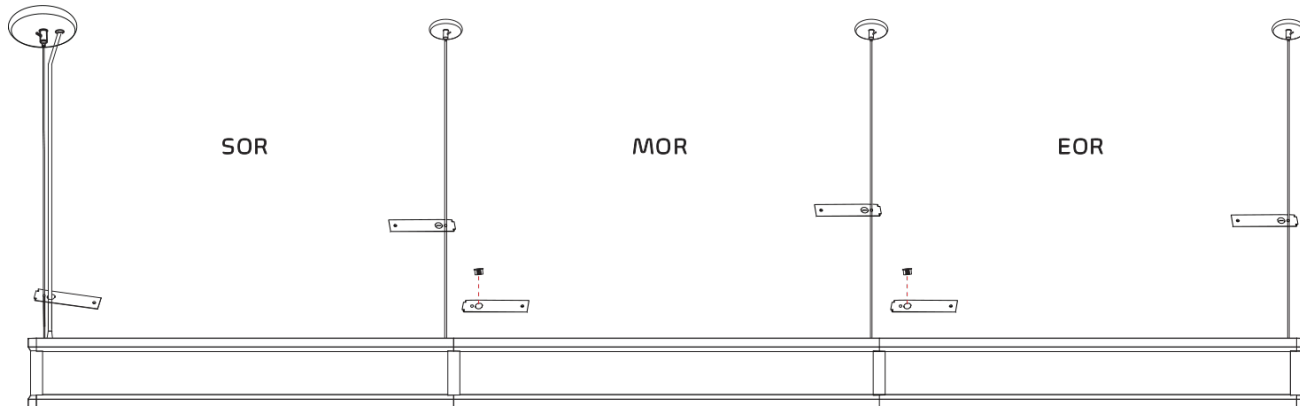

2-1: Joint multiple fixtures together. All continuous runs can be hung one at a time, in order, starting with the SoR, then each fixture sequentially, finishing with the EoR.
2-2: Adjust aircraft suspension cable with leveling tools.

Adjust the height of luminaire. Luminaire can be raised by pulling cable throughout the gripper and can be lowered by depressing the top cylinder on the gripper which pulls the luminaire down.

Repeat Hang/Join/Seam Finishing steps until Run is completed.

INSTALLATION MANUAL

MULTIPLE LUMINAIRES INSTALLATION (Caution: Before beginning installation turn off the circuit breaker and light switch)

STEP 3: Hang Luminaire(s) and wiring - SoR

Screw both bottom parts of aircraft cables clockwise and secure them on top of housing making sure they hang the lights.

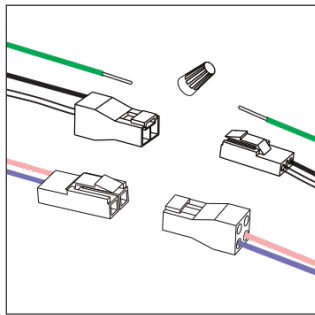

3-1

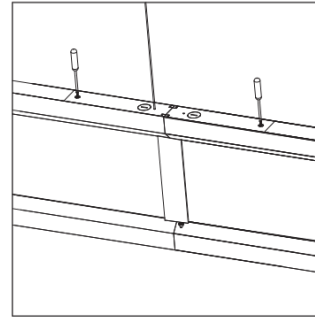

3-2

3-1: Secure cover plates on ends of the fixture.

3-2: Zip tight power cord & aircraft suspension cable with the cable tie.

Leave the protective bag and protective films on the fixtures until construction is complete.

The maximum connection of each input line is less than 40FT(1200CM) in 120AC, less than 80FT (2400CM) in 230AC, less than 100FT(3000CM) in 277AC.

TROUBLE SHOOTING

CARE AND MAINTENANCE

PROBLEM	POSSIBLE CAUSE	SOLUTION	CAUTION: Before attempting to clean the fixture, disconnect the power to the fixture by turning the breaker off or removing the fuse from the fuse box. This LED light fixture is made from quality materials that will last many years with minimum care and maintenance. You may want to clean the fixture with a soft cloth periodically. To maintain the best appearance of the fixture, do not use cleaners with chemicals, solvents or harsh abrasives. Do not use liquid cleaner on the LEDs, LED driver, or wiring inside the light fixture.
Light will not come on	A. Light switch is turned off. B. Fuse is blown or circuit breaker is turned off. C. Incorrect circuit wiring	A. Turn light switch on B. Replace fuse or turn circuit breaker on C. Verify that fixture is wired properly	