

# EDGE

## Vertical-lit Troffer

MODEL NO.	TYPE	PROJECT/DATE
-----------	------	--------------

### KEY FEATURES

- Vertical lit provides direct/indirection low-glare visual comforting illumination
- Shallow yet rigid housing with standard CCT changeable option
- Circadian tunable white controls by wireless lighting control option available
- Decorative color strip option available to add visual character
- Antimicrobial finish option available for healthcare application

### TECHNICAL SUMMARY

SIZE:	1'x4', 2'x2', 2'x4'
WATTAGE:	20W/30W/40W, 40W/50W/60W (Available in 2x4)
LUMEN/EFFICACY	Up to 6500LM* / up to 125LM/W
INPUT VOLTAGE	120-277Vac / 120-347Vac*
AVAILABLE CCT/CRI	35/40K changeable/ 2700K-4000 tunable white* / CRI >80, CRI >90*
CONTROL	0-10V 1%, Bi-level occupancy & daylight sensor*, Lutron Athena Wireless control*
VALIDATIONS	ETL & cETL damp location listed, IC rated, FCC compliant, RoHS compliant, DLC 5.1 listed
LIFETIME	L70>80,000 hours, 5 year warranty
OPERATION TEMP.	-5°F ~ 104°F (AC) / 34°F ~ 104°F (with EM)
FINISH	Matte White, Antimicrobial White finish*

\*Delivered lumen may vary, refer to photometric for full performance data



### DIMENSIONS

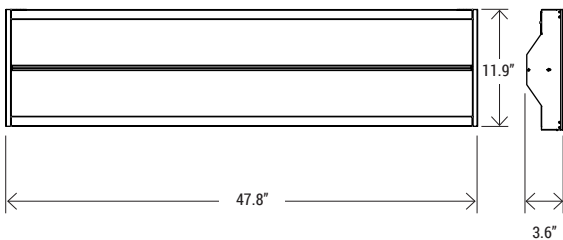

**ED-14**  
8 lbs

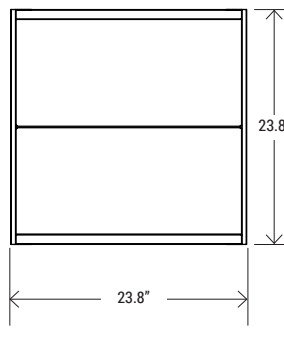

**ED-22**  
8 lbs

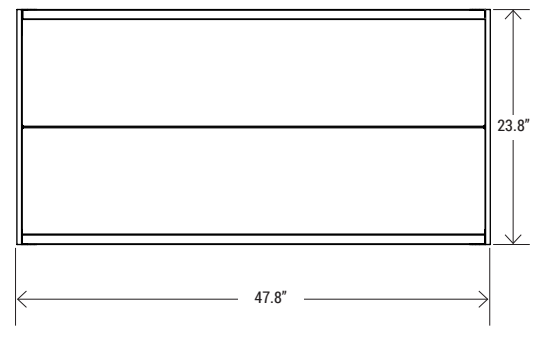

**ED-24**  
16 lbs

MODEL NO.	TYPE	PROJECT/DATE
-----------	------	--------------

### ORDERING INFORMATION

\*Additional cost and/or lead time on customized fixtures may apply.

[ ]	-	[ ]	-	[ ]	-	[ ]	-	[ ]	-	[ ]	-	[ ]
Series	Size	Lumen Package	Voltage	CCT	Control	EM Option	Misc Option					
ED	14 - (1'x4')	<b>43LC</b> (4300/3400/2400LM) <b>Custom</b>	<b>U</b> - (120-277V) <b>*C</b> - (120-347V)	<b>CC</b> - (35K/40K changeable) <b>35K</b> - 3500K <b>40K</b> - 4000K <b>TW</b> - (27K - 40K CCT tunable) A3 only** <b>Custom</b>	<b>C1</b> - 0-10V dimming 1% <b>*C3</b> - Stand alone Bi-level occupancy & daylight sensor <b>*A1</b> - Lutron Athena wireless dimming (A-WN-D01-RF-WH) <b>*A2</b> - Lutron Athena with Bi-level occupancy & daylight (A-WN-D01-OCC-WH) <b>**A3</b> - Lutron Athena tunable white (A-WN-D01-RF-WH) <b>*S1</b> - Silvar wireless control	<b>EM1</b> - 8W EM backup (Factory installed)	<b>AM</b> - Antimicrobial finish <b>RD</b> - Red vertical lit decorative strip <b>BD</b> - blue vertical lit decorative strip <b>GD</b> - Green vertical lit decorative strip					
	22 - (2'x2')	<b>40LC</b> (4000/3000/2000LM) <b>*55LC</b> (5500/4400/3300LM) <b>Custom</b> <small>*Only available in single CCT</small>										
	24 - (2'x4')	<b>46LC</b> (4600/3800/2700LM) <b>*60LC</b> (6500/5500/4500LM) <b>Custom</b> <small>*Only available in single CCT</small>										

### \*AVAILABLE ACCESSORIES: (SOLD SEPARATELY)



**C3**  
ANT-4E



**RC-100**  
ANT-4E remote programmer



**BP-RMK-2x2/BP-RMK-2x4**  
Recessed dry wall flange mount kit



**TT-CMKW-2x2/TT-CMKW-2x4**  
Surface mount kit

### \*Accessories

- RC-100** - ANT-4E remote programmer
- BP-RMK-2x2/BP-RMK-2x4** - Recessed dry wall flange mount kit
- TT-CMKW-2x2/TT-CMKW-2x4** - Surface mount kit
- MCF-185-8F** - Metal-clad flex whip, 18-gauge, 5 conductors Black/White/Green/Pink/Violet
- MCF-186-8F** - Metal-clad flex whip, 18-gauge, 6 conductors Black(Switch hot)/Black(24/7 hot)/White/Green/Pink/Violet

\*Available accessories sold separately

\*\*Lutron Athena A3 option is only available for 1'x4' 4300LM, 2'x2' 4000LM and 2'x4' 4600LM

\*Lutron Athena wireless processor or Clear Connect gateway – Type X is required to operate an Athena wireless node in an Athena control system via a simple setup process using an iOS® or Android® compatible app. Refer to Lutron Athena spec for details.

\*Lutron Athena wireless control is up to 100 Clear Connect – Type X devices per processor. Refer to Lutron Athena spec for details.

### SPECIFICATIONS

#### CONSTRUCTION

Shallow 3.63" rugged cold-rolled steel frame finished with polyester coating after fabrication with embossed facets. Injection laser-cut acrylic light guide panel with excellent low glare transparent and direct/indirect distribution.

#### FINISH

Polyester coated finish in powder coating after fabrication with embossed facets, Antimicrobial finish option available.

#### OPTICS/DIFFUSER

Injection molded vertical anidolic PMMA light guide panel provides wide and visual comfortable illumination. Decorative colored strip option available

#### ELECTRICAL

Long-life LEDs standard 3500K and 4000K field selectable, 120-277Vac driver with adjustable output lumen and standard 0-10V to 1% dimming, Lutron Antenna wireless, Silvar are available.

#### MOUNTING

Drop ceiling lay-in, Dry wall ceiling recess via flange kit.

#### VALIDATIONS





ETL & cETL damp location listed, IC rated, FCC compliant, RoHS, DLC 5.1 listed  
(Not all product variations listed on this page are DLC qualified. Visit <https://www.designlights.org/qpl> to confirm qualification.)

MODEL NO.	TYPE	PROJECT/DATE
-----------	------	--------------



### Athena

An uncompromising solution. The Athena lighting control system empowers architects, lighting designers, electrical engineers, and facility managers with a native network of lighting, lighting controls, shades, and cloud-connected software that deliver exceptional experiences and building management.

	<p><b>A-WN-D01-RF-WH</b> Plenum rated and can be installed above the ceiling for wireless control of a fixture without any impact on fixture aesthetics.</p>
	<p><b>A-WN-D01-RF-BK</b> Plenum rated and can be installed above the ceiling for wireless control of a fixture without any impact on fixture aesthetics.</p>
	<p><b>A-WN-D01-OCC-WH</b> Provides wireless control of the fixture and includes a passive infrared (PIR) sensor for occupancy and a daylight sensor.</p>
	<p><b>A-WN-D01-OCC-BK</b> Provides wireless control of the fixture and includes a passive infrared (PIR) sensor for occupancy and a daylight sensor.</p>



DLC Listed  
Visit <https://www.designlights.org/qpl> to confirm qualification.)

SPITZER MODEL NUMBER	DLC PRODUCT ID
ED14-43LC-U-CC-C1	S-3MGKQ1
ED22-40LC-U-CC-C1	S-WDSPLX
ED24-46LC-U-CC-C1	S-TR2J3M