

CELIA CR

Ceiling Mount Round Architectural Concrete Cylinder

MODEL NO.	TYPE	PROJECT/DATE
-----------	------	--------------

KEY FEATURES

- Visual appealing concrete stone material housing creates an exceptional architectural texture perception
- Highly resistant to rust and decay caused by high humidity, chemical or other environmental factors
- Regressed lens with 90 CRI LED creates a low-glare, visual comfortable direct and indirect illumination

TECHNICAL SUMMARY

SIZE:	4" and 6" aperture
WATTAGE:	4" direct: 10W, 6" direct: 15W
LUMEN*	4" direct: 1000LM, 6" direct: 1400LM
EFFICACY	UP TO 95 LM/W at 3000K
INPUT VOLTAGE	120-277Vac
AVAILABLE CCT/CRI	Available in 3000K, 4000K, Custom / 90 CRI standard
CONTROL	On/off with 0-10V dim to 1% to off driver
VALIDATIONS	ETL & cETL wet location listed, IP54 and IK06 rated, FCC, RoHS
LIFETIME	L90>50,000 hours, 5 year warranty
OPERATION TEMP.	Normal: -13°F ~ 113°F / Emergency: 0°F ~ 113°F
FINISH	Standard: Dark Gray, Silver Gray / Made to order: Terracotta Red



AVAILABLE FINISH: SHOWN IS 4"



*Delivered lumen may vary, refer to photometric for full performance data



DIMENSIONS

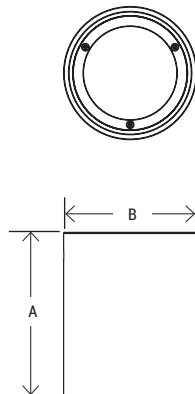

Size	A	B	WEIGHT
4" (Ceiling Light)	5.6"	4.5"	4.2 lbs
6" (Ceiling Light)	6.4"	5.7"	6.4 lbs

CELIA CR

Ceiling Mount Round Architectural Concrete Cylinder

MODEL NO.	TYPE	PROJECT/DATE
-----------	------	--------------

ORDERING INFORMATION

*Additional cost and/or lead time on customized fixtures may apply.

<input type="text"/>	-	<input type="text"/>	-	<input type="text"/>	-	<input type="text"/>	-	<input type="text"/>	-	<input type="text"/>	-	<input type="text"/>	-	<input type="text"/>
Series	Style	Size	Lumen Package	Input Voltage	CCT	Light Distribution	Control	Finish						
CEL	CR - (Ceiling mount round)	4D - 4" direct only	10L - 1000LM/10W	U - (120-277V)	30K - (3000K) 40K - (4000K) Custom*	NC - (Narrow degree with clear lens) GC - (General degree with clear lens)	C1 - (on/off with 0-10V dimmable driver)	DG - (Dark Gray) SG - (Silver Gray) TR* - (Terracotta Red) Custom*						
		6D - 6" direct only	14L - 1400LM/15W					* = made to order						

AVAILABLE FINISH: SHOWN IS 6"



Dark Gray



Silver Gray



Terracotta Red (custom)

*AVAILABLE ACCESSORIES: (SOLD SEPARATELY)

*Accessories

- SP-EM40-AC-C - 40W remote mount field install emergency backup inverter
- SP-EM40-SW - Remote test switch for SP-EM40-AC-C
- JB-4-RD-WH/BD/BL/AL - Commercial Electrical Waterproof Box

SPECIFICATIONS

CONSTRUCTION

Housing constructed with proprietary natural composite mix material of concrete and stones with stainless steel lens cover and screw.

FINISH

Natural concrete and stone mix finish available in dark gray and silver gray finish, highly resistant to rust and decay caused by environmental factors.

OPTICS/DIFFUSER

Embossed aluminum reflector with harden glass lens, available in general 36 degree and narrow 24 degree beam angle, direct and omni directional.

ELECTRICAL

Long life COB LED package, 90 CRI standard, SDCM 5-step binning, Outdoor rated LED driver with input voltages of 120-277Vac with 0-10V dimming, dim to 1% to off.

MOUNTING

Surface, ceiling mount

VALIDATIONS

ETL and cETL wet location listed, IP54 and IK06 rated, FCC, RoHS